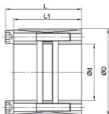

- **Ma** → screw tightening torque (Nm)
- **Mt** → transmissible torque(with Fax = 0) (Nm)
- **Fax** → axial force (with Mt = 0) (kN)
- **Ps** → specific pressure on shaft (N/mm²)
- **Ph** → specific pressure on hub (N/mm²)

- **Ma** → 螺絲鎖緊扭矩 (Nm)
- **Mt** → 傳遞扭力 (Nm)
- **Fax** → 軸向推力 (kN)
- **Ps** → 軸面負荷壓力 (N/mm²)
- **Ph** → 殼面負荷壓力 (N/mm²)

**SPECIFICATION:
TYPE JF**

Dimensions			Screws			Performances		
d x D	L	L1	Size	Ma	Mt	Fax	Ps	Ph
25 x 50	51	45	M6	17	840	67	295	134
30 x 55	51	45	M6	17	1,000	67	246	134
32 x 60	51	45	M6	17	1,200	78	190	101
35 x 60	51	45	M6	17	1,400	78	174	101
38 x 65	51	45	M8	41	2,700	144	296	150
40 x 65	51	45	M8	41	2,900	144	281	150
42 x 75	51	45	M8	41	3,000	144	268	150
45 x 75	51	45	M8	41	3,200	144	250	150
48 x 80	72	64	M8	41	4,000	185	207	124
50 x 80	72	64	M8	41	4,100	185	198	124
55 x 85	72	64	M8	41	5,100	185	203	131
60 x 90	72	64	M8	41	6,200	206	207	138
65 x 95	72	64	M8	41	6,700	206	191	131
70 x 110	88	78	M10	83	11,800	338	229	145
75 x 115	88	78	M10	83	12,700	338	213	139
80 x 120	88	78	M10	83	14,900	372	220	147
85 x 125	88	78	M10	83	15,800	372	207	141
90 x 130	88	78	M10	83	18,200	405	213	148
95 x 135	88	78	M10	83	19,300	405	202	142
100 x 145	112	100	M12	145	27,700	555	210	145
110 x 155	112	100	M12	145	33,300	605	209	148
120 x 165	112	100	M12	145	42,400	706	223	162
130 x 180	130	118	M14	230	53,700	826	201	145
140 x 190	130	118	M14	230	67,400	963	217	160
150 x 200	130	118	M14	230	77,400	1,030	217	163
160 x 210	130	118	M14	230	88,100	1,100	217	166
170 x 225	162	146	M16	355	111,000	1,310	186	141
180 x 235	162	146	M16	355	126,000	1,410	188	144
190 x 250	162	146	M16	355	142,000	1,500	190	145
200 x 260	162	146	M16	355	160,000	1,500	181	139

ORDERING EXAMPLE:

型式 Type	尺寸 Size (d x D)
JF	50 x 80