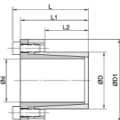

- **Ma** → screw tightening torque (Nm)
- **Mt** → transmissible torque(with Fax = 0) (Nm)
- **Fax** → axial force (with Mt = 0) (kN)
- **Ps** → specific pressure on shaft (N/mm²)
- **Ph** → specific pressure on hub (N/mm²)

- **Ma** → 螺絲鎖緊扭矩 (Nm)
- **Mt** → 傳遞扭力 (Nm)
- **Fax** → 軸向壓力 (kN)
- **Ps** → 軸面負荷壓力 (N/mm²)
- **Ph** → 軸殼面負荷壓力 (N/mm²)

SPECIFICATION:
TYPE JB

Dimensions				Screws			Performances				
d x D	D1	L	L1	L2	Size	Ma5	Mt	Fax	Ps	Ph	
6 x 14	25	24	21	10	M3	5	21	7	273	134	
7 x 15	27	29	25	12	M4	5	25	7	199	104	
8 x 15	27	29	25	12	M4	5	28	7	177	104	
9 x 16	28	30	26	14	M4	5	42	9	182	112	
10 x 16	28	30	26	14	M4	5	47	9	166	112	
11 x 18	32	30	26	14	M4	5	52	9	149	99	
12 x 18	32	30	26	14	M4	5	57	9	138	99	
13 x 23	38	30	26	14	M4	5	61	9	122	78	
14 x 23	38	30	26	14	M4	5	66	9	114	78	
15 x 24	45	42	36	16	M6	17	130	17	167	115	
16 x 24	45	42	36	16	M6	17	130	17	159	115	
17 x 26	47	44	38	18	M6	17	190	22	179	130	
18 x 26	47	44	38	18	M6	17	200	22	169	120	
19 x 27	49	44	38	18	M6	17	210	22	160	122	
20 x 28	50	44	38	18	M6	17	220	22	152	114	
22 x 32	54	51	45	25	M6	17	290	22	100	74	
24 x 34	56	51	45	25	M6	17	400	33	136	104	
25 x 34	56	51	45	25	M6	17	420	33	133	104	
28 x 39	61	51	45	25	M6	17	470	33	117	91	
30 x 41	62	51	45	25	M6	17	500	33	109	86	
32 x 43	65	56	50	30	M6	17	710	45	137	110	
35 x 47	69	56	50	30	M6	17	780	45	99	79	
38 x 50	72	56	50	30	M6	17	850	45	91	74	
40 x 53	75	56	50	30	M6	17	890	45	86	70	
42 x 55	78	56	50	32	M6	17	940	45	82	67	
45 x 59	85	73	65	40	M8	41	1,900	82	102	82	
48 x 62	87	78	70	45	M8	41	2,000	82	96	78	
50 x 65	92	78	70	45	M8	41	2,100	82	91	75	
55 x 71	98	83	75	50	M8	41	2,500	93	77	63	
60 x 77	104	83	75	50	M8	41	2,600	93	70	58	
65 x 84	111	83	75	50	M8	41	3,000	93	65	53	
70 x 90	119	101	91	60	M10	83	5,300	152	84	69	
75 x 95	126	101	91	60	M10	83	5,700	152	78	65	
80 x 100	131	106	96	65	M10	83	8,100	203	96	83	
85 x 106	137	106	96	65	M10	83	8,600	203	92	78	
90 x 112	144	106	96	65	M10	83	9,100	203	87	74	
95 x 120	153	106	96	65	M10	83	11,200	236	95	80	
100 x 125	162	114	102	65	M12	145	15,100	303	108	92	

ORDERING EXAMPLE:

型式 Type	尺寸 Size (d x D)
JB	50 x 65