

- **Ma** → screw tightening torque (Nm)
- **Mt** → transmissible torque (with Fax = 0) (Nm)
- **Fax** → axial force (with Mt = 0) (kN)
- **Ps** → specific pressure on shaft (N/mm²)
- **Ph** → specific pressure on hub (N/mm²)

- **Ma** → 螺絲鎖緊扭矩 (Nm)
- **Mt** → 傳遞扭矩 (Nm)
- **Fax** → 軸向推力 (kN)
- **Ps** → 軸面負荷壓力 (N/mm²)
- **Ph** → 軸套面負荷壓力 (N/mm²)

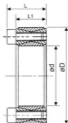

SPECIFICATION:

TYPE JA

Dimensions				Screws			Performances		
d x D	L	L1	Size	Ma	Mt	Fax	Ps	Ph	
20 x 47	26	20	M6	16	270	27	240	102	
22 x 47	26	20	M6	16	300	27	218	102	
24 x 50	26	20	M6	16	330	27	200	96	
25 x 50	26	20	M6	16	340	27	192	96	
26 x 55	26	20	M6	16	570	41	257	131	
30 x 55	26	20	M6	16	610	41	240	131	
32 x 60	26	20	M6	16	660	41	225	120	
35 x 60	26	20	M6	16	720	41	205	120	
38 x 65	26	20	M6	16	970	51	236	138	
40 x 65	26	20	M6	16	1000	51	225	138	
42 x 75	32	24	M8	38	1600	76	264	148	
45 x 75	32	24	M8	38	1700	76	246	148	
46 x 80	32	24	M8	38	1800	76	231	139	
50 x 80	32	24	M8	38	1900	76	222	139	
55 x 85	32	24	M8	38	2600	93	247	160	
60 x 90	32	24	M8	38	2800	95	231	154	
65 x 95	32	24	M8	38	3100	95	213	146	
70 x 110	38	28	M10	70	4900	140	251	160	
75 x 115	38	28	M10	73	5500	150	245	160	
80 x 120	38	28	M10	75	6000	150	236	157	
85 x 125	38	28	M10	75	6400	150	222	151	
90 x 130	38	28	M10	75	6600	150	210	145	
95 x 135	38	28	M10	72	8100	170	227	160	
100 x 145	45	33	M12	120	9800	200	232	160	
110 x 155	45	33	M12	130	11500	210	225	160	
120 x 165	45	33	M12	130	13500	220	220	160	
130 x 180	50	38	M12	130	19000	290	202	148	
140 x 190	50	38	M12	130	22000	320	206	152	
150 x 200	50	38	M12	130	26000	350	210	157	
160 x 210	50	38	M12	130	29500	370	210	160	
170 x 225	58	44	M14	200	37000	440	207	156	
180 x 235	58	44	M14	200	42000	470	209	160	
190 x 250	66	52	M14	200	52500	560	195	148	
200 x 260	66	52	M14	200	59500	600	196	153	

ORDERING EXAMPLE:

型式 Type	尺寸 Size (d x D)
JA	50 x 80